

Auto door sensor [ADS-AF/AE]

■ Specifications

Model		ADS-AF	ADS-AE
Appearances			
Cover color		Silver	
Power supply		24-240VAC ±10% 50/60Hz, 24-240VDC ±10%(ripple P-P: Max. 10%)	12-24VAC ±10% 50/60Hz, 12-24VDC ±10%(ripple P-P: Max. 10%)
Power consumption		Max. 4VA(at 240VAC)	Max. 2VA(at 24VAC)
Control output	Contact type	1a	
	Contact capacity※1	50VDC 0.1A(Resistive load)	
Relay life cycle		Mechanical: Min. 20,000,000 times, Electrical: Min. 50,000 times	
Mounting height		2.0m to 2.7m(max. sensing distance: 3m)	
Sensing method		Infrared reflection method	
Output holding time		Time delay approx. 0.5sec.	
Holding time of stationary sensing		Selectable 2sec., 7sec., 15sec. (selectable by holding time setting switch)	
Interference prevention		H, L (selectable by interference prevention switch)	
Front sensing area		7.5°, 14.5°, 21.5°, 28.5°: 4 steps variable (adjusting by angle adjuster)	
Adjustable sensing area		(1, 2, 3 Area), (7, 8, 9 Area) Eliminate each by each : Adjusting with eliminating right/left sensing area lever	
Light source		Infrared emitting diode(modulated)	
Indicator		Operation indicator: Orange, Green, Red	
Connection method		Connector wire connection	
Insulation resistance		Min. 20MΩ(at 500VDC megger)	
Noise resistance		±2,000V the square wave noise(pulse width:1μs) by the noise simulator	
Dielectric strength		1,000VAC 50/60Hz for 1 minute	
Vibration		1.5mm amplitude at frequency of 10 to 55Hz in each of X, Y, Z directions for 2 hours	
Shock		100m/s² (approx. 10G) in each of X, Y, Z directions for 3 times	
Environment	Ambient illumination	Sunlight: Max. 3,000lx, Incandescent lamp: Max. 3,000lx (receiver illumination)	
	Ambient temperature	-20°C to 50°C, storage: -20 to 70°C	
	Ambient humidity	35 to 85%RH, storage: 35 to 85%RH	
Accessory		Cable: 2.5m, Mounting screw: 2EA, Mounting template	
Protection		IP50(IEC standard)	
Material		• Case: ABS • Lens: Acryl • Lens cover: Acryl	
Unit weight		Approx. 320g	

※1: Do not use Load which is beyond the rated capacity of contact point of Relay.

It can cause bad insulation, contact fusion, bad contact, relay breakdown, and fire etc.

※The temperature or humidity mentioned in Environment indicates a non freezing or condensation environment.

■ Dimensions

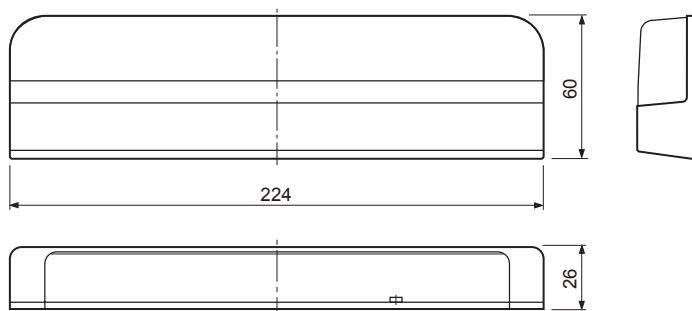

(unit:mm)

Door side sensor [ADS-SE]

Specifications

Model	ADS-SE	
Appearances		
Sensing type	Through-beam type	
Sensing distance	0 to 10m	
Power supply	12-24VAC/DC $\pm 10\%$ (ripple P-P: Max. 10%)	
Power/Current consumption	AC: Max. 2VA / DC: Max. 50mA	
Contact output ^{※1}	<ul style="list-style-type: none"> • Contact capacity: 50VDC 0.3A(resistive load) • Contact composition: 1c • Relay life cycle: Mechanical- Min. 5,000,000 operations, Electrical- Min. 100,000 operations 	
Response time	Approx. 50ms(from light OFF)	
Output holding time	Approx. 500ms(from light ON)	
Available sensor set	2set	
Indicator	Operation indicator: Red, Green	
Light source	Infrared LED(850nm modulated)	
Environment	Ambient illumination	Sunlight: Max. 100,000lx (receiver illumination)
	Ambient temperature	-20 to 55°C, storage: -25 to 60°C
	Ambient humidity	35 to 85%RH, storage: 35 to 85%RH
Protection	IP30(IEC standard)	
Sensor cable length	10m	
Material	• Case: ABS • Sensing part: PMMA	
Accessory	Sensor: 1 set(ADS-SH), Fixing bolt for controller: 2 pieces	
Unit weight	Approx. 300g	

※1: Do not use Load which is beyond the rated capacity of contact point of Relay.

It can cause bad insulation, contact fusion, bad contact, relay breakdown, and fire etc.

※Please purchase 1 set of sensor separately when mounting 2 sets of sensor.

※The mounting bracket of sensor (ADS-SB12, ADS-SB10) is sold separately.

※It is enable to purchase a controller (ADS-SEC) separately.

※The temperature or humidity mentioned in Environment indicates a non freezing or condensation environment.

Dimensions

(unit: mm)

Controller (ADS-SEC)

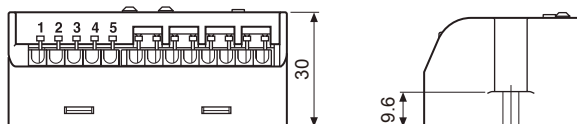
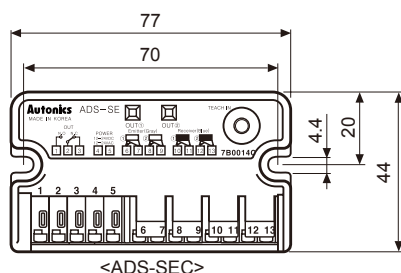

Sensors (ADS-SH)

One push type

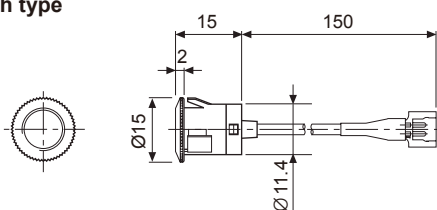

Screw type

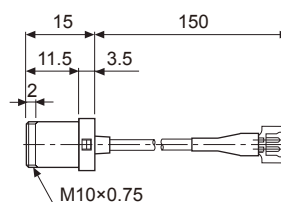



Photo electric sensor
Fiber optic sensor
Door/Area sensor
Proximity sensor
Pressure sensor
Rotary encoder
Connector/ Socket
Temp. controller
SSR/ Power controller
Counter
Timer
Panel meter
Tacho/ Speed/ Pulse meter
Display unit
Sensor controller
Switching mode power supply
Stepper motor& Driver&Controller
Graphic/ Logic panel
Field network device

Door side sensor [ADS-SE1/2]

Specifications

Model	ADS-SE1(1-channel)	ADS-SE2(2-channel)
Appearances		
Sensing type	Through-beam type	
Sensing distance	0 to 10m	
Power supply	12-24VAC $\pm 10\%$ 50/60Hz / 12-24VDC $\pm 10\%$ (ripple P-P: Max. 10%)	
Power consumption/Current	AC: Max. 2VA, DC: Max. 50mA	
Control output ^{※1}	<ul style="list-style-type: none"> • Contact capacity: 50VDC 0.3A(resistive load) • Contact composition: 1c • Relay life cycle: Mechanical- Min. 5,000,000 operations, Electrical- Min. 100,000 operations 	
Response time	Approx. 50ms (from light OFF)	
Output holding time	Approx. 500ms (from light ON)	
Available sensor set	1 channel	2 channels
Indicator	OUT1 indicator: red, OUT2 indicator: green	
Light source	Infrared LED(850nm modulated)	
Vibration	1.5mm amplitude at frequency of 10 to 55Hz (for 1min.) in each of X, Y, Z directions for 2 hours	
Shock	500m/s ² (approx. 50G) in each of X, Y, Z directions for 3 times	
Environment	Ambient illumination	Sunlight: Max. 100,000lx (receiver illumination)
	Ambient temperature	-20 to 55°C, storage: -25 to 60°C
	Ambient humidity	35 to 85% RH, storage: 35 to 85% RH
Protection	IP30(IEC standard)	
Sensor cable length	5m	
Cable	Ø2.4mm, 1-wire, length: 5m(AWG26, core diameter: 0.16mm, number of cores: 7, insulator out diameter: Ø1.32mm)	
Material	• Case: ABS • Lens: PMMA	
Accessory	Sensor 1set(ADS-SHP), Fixing bolt (M4×20) for controller: 2EA	
Approval	CE	
Unit ^{※2}	Approx. 450g (approx. 300g)	

※1: Do not use Load which is beyond the rated capacity of contact point of Relay.

It can cause bad insulation, contact fusion, bad contact, relay breakdown, and fire etc.

※2: The weight is with packaging and the weight in parentheses is only unit weight.

※Please purchase 1 set of sensor separately when mounting 2 sets of sensor.

※The mounting bracket of sensor (ADS-SB12, ADS-SB10) is sold separately.

※It is enable to purchase a controller (ADS-SEC1/2) separately.

※The temperature or humidity mentioned in Environment indicates a non freezing or condensation environment.

Dimensions

(unit:mm)

Controller(ADS-SEC1/2)

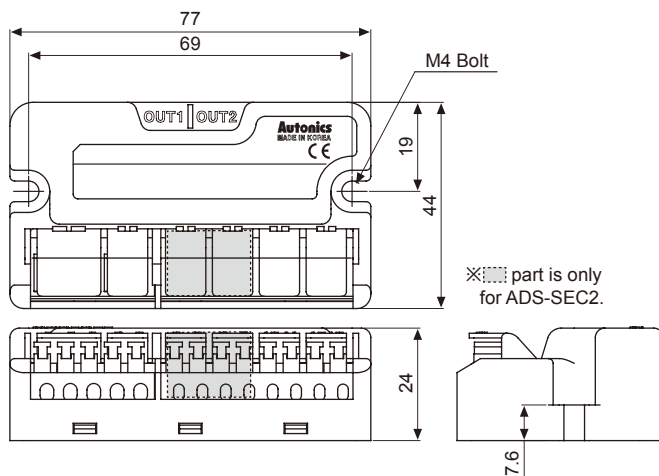

Sensor(ADS-SHP)

One push method

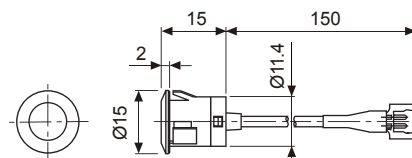

Screw method

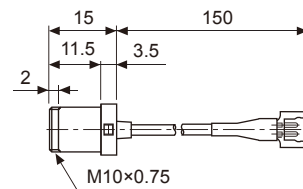

Cross-beam Area Sensor [BWC Series]

■Specifications

Model	BWC40-□□H		BWC40-□□HD		BWC80-14H		BWC80-14HD		
Appearances	<div><div>NEW</div><div>CE</div><div></div></div>								
Sensing type	Through-beam type								
Sensing distance	1.0 to 7.0m								
Sensing target	Opaque material of min. Ø50mm				Opaque material of min. Ø90mm				
Optical axis pitch	40mm				80mm				
Number of optical axes	4/10/12/16/18/20EA				14EA				
Sensing height	120 to 760mm				1,040mm				
Beam pattern	3-point cross-beam netting type								
Power supply	12-24VDC ±10%(ripple P-P: max. 10%)								
Reverse polarity protection	Built-in								
Current consumption	Max. 100mA								
Control output	NPN open collector output •Load voltage: max. 30VDC, •Load current: Max. 100mA, •Residual voltage: Max. 1V								
	Operation mode	Light ON		Dark ON		Light ON		Dark ON	
	Short-circuit protection	Built-in							
	Response	Max. 50ms							
Light source	Infrared LED(850nm modulated light type)								
Synchronization type	Timing method by synchronous cable								
Self-diagnosis	Transmitted-received light monitoring, direct light monitoring, output circuit monitoring								
Interference protection	Interference protection by frequency changing setting								
Environment	Ambient illumination	Ambient light: Max. 100,000lx (received light side illumination)							
	Ambient temperature	-10 to 55°C, storage: -20 to 60°C							
	Ambient humidity	35 to 85%RH, storage: 35 to 85%RH							
Protection	IP65(IEC standard)								
Noise resistance	±240V the square wave noise (pulse width: 1μs) by the noise simulation								
Dielectric strength	1,000VAC 50/60Hz for 1 min.								
Insulation resistance	Min. 20MΩ (at 500VDC megger)								
Vibration	1.5mm amplitude at frequency of 10 to 55Hz(for 1 min.) in each of X, Y, Z directions for 2 hour								
Shock	500m/s ² (approx. 50G) in each of X, Y, Z directions for 3 times								
Material	• Case: Aluminum • Sensing part and indicator: Acrylic								
Cable	Ø5mm, 4-core, length: 300mm, M12 connector								
Accessory	Bracket A: 4EA, Bracket B: 4EA, Fixing bolt: 8EA								
Approval	CE								
Unit weight	Approx. 1.7kg (based on BWC80-14H)								

✕The temperature or humidity mentioned in Environment indicates a non freezing or condensation environment.

Photo electric sensor
Fiber optic sensor
Door/Area sensor
Proximity sensor
Pressure sensor
Rotary encoder
Connector/Socket
Temp. controller
SSR/ Power controller
Counter
Timer
Panel meter
Tacho/ Speed/ Pulse meter
Display unit
Sensor controller
Switching mode power supply
Stepper motor& Driver&Controller
Graphic/ Logic panel
Field network device

■ Dimensions

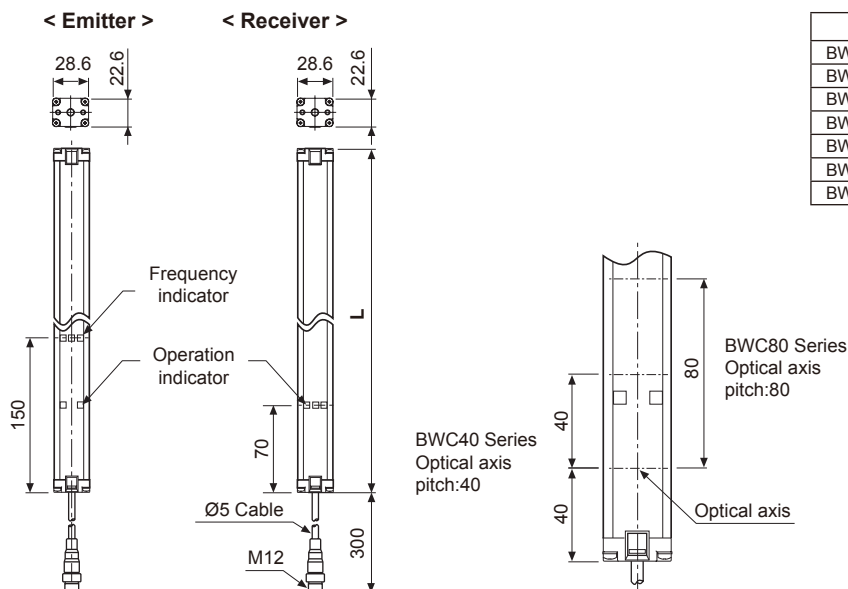

(unit: mm)



Model	L(mm)
BWC40-04H/HD	180mm
BWC40-10H/HD	420mm
BWC40-12H/HD	500mm
BWC40-16H/HD	660mm
BWC40-18H/HD	740mm
BWC40-20H/HD	820mm
BWC80-14H/HD	1140mm

Area sensor [BW Series]

■ Specifications

Model	NPN open collector output (standard)	BW20-08 BW20-12 BW20-16	BW20-20 BW20-24 BW20-28	BW20-32 BW20-36 BW20-40	BW20-44 BW20-48	BW40-04 BW40-06 BW40-08	BW40-10 BW40-12 BW40-14	BW40-16 BW40-18 BW40-20	BW40-22 BW40-24
	PNP open collector output	BW20-08P BW20-12P BW20-16P	BW20-20P BW20-24P BW20-28P	BW20-32P BW20-36P BW20-40P	BW20-44P BW20-48P	BW40-04P BW40-06P BW40-08P	BW40-10P BW40-12P BW40-14P	BW40-16P BW40-18P BW40-20P	BW40-22P BW40-24P
Appearances									
Sensing type	Through-beam								
Sensing distance	0.1 to 7m								
Sensing target	Opaque materials of Min.Ø30mm					Opaque materials of Min.Ø50mm			
Optical axis pitch	20mm					40mm			
Number of optical axis	8 to 48EA					4 to 24EA			
Sensing width	140 to 940mm					120 to 920mm			
Power supply	12-24VDC ±10%(ripple P-P: Max. 10%)								
Reverse polarity protection	Built-in								
Current consumption	Emitter: Max. 80mA, Receiver: Max. 80mA								
Control output	NPN or PNP open collector output • Load voltage: Max. 30VDC • Load current: Max. 100mA • Residual voltage - NPN: Max. 1V, PNP: Min. 2.5V								
Operation mode	Light ON (fixed)								
Short-circuit protection	Built-in								

Area sensor [BW Series]

Specifications

Model	NPN open collector output (standard)	BW20-08	BW20-20	BW20-32	BW20-44	BW40-04	BW40-10	BW40-16	BW40-22
	PNP open collector output	BW20-12	BW20-24	BW20-36	BW20-48	BW40-06	BW40-12	BW40-18	BW40-24
Model	NPN open collector output (standard)	BW20-16	BW20-28	BW20-40		BW40-08	BW40-14	BW40-20	
	PNP open collector output	BW20-08P	BW20-20P	BW20-32P	BW20-44P	BW40-04P	BW40-10P	BW40-16P	BW40-22P
Model	NPN open collector output (standard)	BW20-12P	BW20-24P	BW20-36P	BW20-48P	BW40-06P	BW40-12P	BW40-18P	BW40-24P
	PNP open collector output	BW20-16P	BW20-28P	BW20-40P		BW40-08P	BW40-14P	BW40-20P	
Response time		Max. 12ms							
Light source		Infrared LED(850nm modulated)							
Synchronization type		Synchronized by synchronous line							
Self-diagnosis		Ambient light monitoring, Emitter/Receiver light circuit monitoring, Output circuit monitoring							
Interference protection		Interference protection by master/slave function							
Environment	Ambient illumination	Sunlight: 10,000lx (received light side illumination)							
	Ambient temperature	-10 to 55°C, storage: -20 to 60°C							
	Ambient humidity	35 to 85%RH, storage: 35 to 85%RH							
Noise resistance		±240V the square wave noise (pulse width: 1μs) by the noise simulation							
Dielectric strength		1,000VAC 50/60Hz for 1minute							
Insulation resistance		Min. 20MΩ(at 500VDC megger)							
Vibration		1.5mm amplitude at frequency of 10 to 55Hz(for 1 min.) in each of X, Y, Z directions for 2 hour							
Shock		500m/s ² (approx. 50G) in X, Y, Z directions for 3 times							
Protection		IP65(IEC standard)							
Material		• Case: Aluminum • Cover, Sensing part: Acrylic							
Cable		Ø5mm, 4-core, length: 300mm, M12 connector							
Accessory		Bracket A: 4EA, Bracket B: 4EA, Fixing bolt: 8EA							
Approval		CE							
Unit weight		Approx. 1.4kg(for 48 optical axes)							

※The temperature or humidity mentioned in Environment indicates a non freezing or condensation environment.

Dimensions

<Emitter> <Receiver>

(unit: mm)

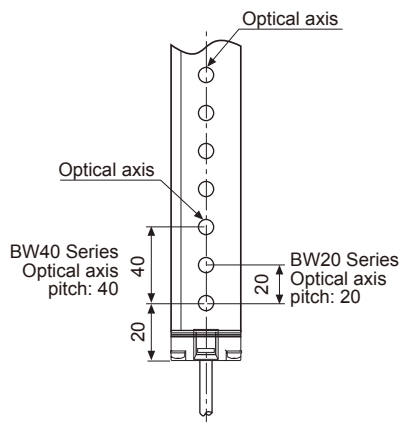
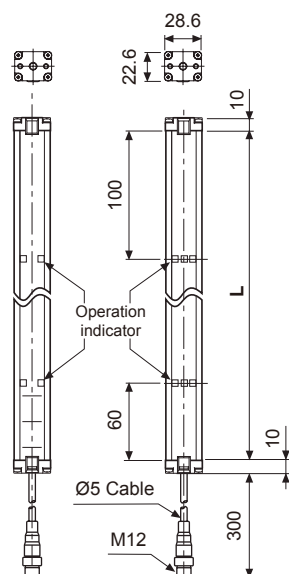

Model	L(mm)	Model	L(mm)
BW20-08(P)	160	BW20-32(P)	640
BW40-04(P)		BW40-16(P)	
BW20-12(P)	240	BW20-36(P)	720
BW40-06(P)		BW40-18(P)	
BW20-16(P)	320	BW20-40(P)	800
BW40-08(P)		BW40-20(P)	
BW20-20(P)	400	BW20-44(P)	880
BW40-10(P)		BW40-22(P)	
BW20-24(P)	480	BW20-48(P)	960
BW40-12(P)		BW40-24(P)	
BW20-28(P)	560		
BW40-14(P)			

■ Dimensions

(unit: mm)

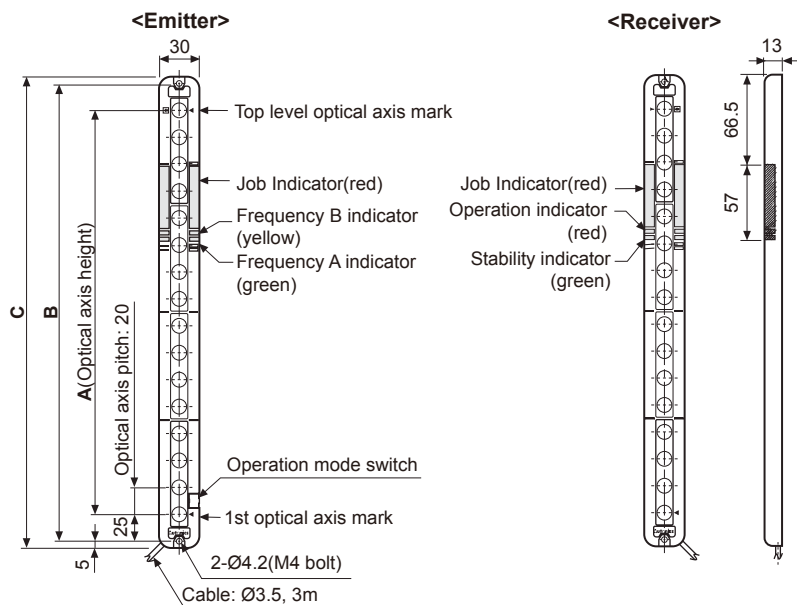

Model	A	B	C
BWP20-08	140	180	190
BWP20-12	220	260	270
BWP20-16	300	340	350
BWP20-20	380	420	430

※Use M4 bolt for installing sensor, and tightening torque should be under 20kgf·cm

Picking sensor [BWP Series]

■ Specifications

Model	NPN open collector output	BWPK25-05
	PNP open collector output	BWPK25-05P
Appearances		
Sensing type		Through-beam
Sensing distance	Long distance mode	0.1 to 3m
	Short distance mode	0.05 to 1m
Sensing target		Opaque materials of Min.Ø35mm
Optical axis pitch		25mm
Number of optical axis		5EA
Sensing width		100mm
Power supply		12-24VDC ±10%(ripple P-P: Max. 10%)
Current consumption		Emitter: Max. 60mA, Receiver: Max. 60mA
Control output		NPN or PNP open collector output • Load voltage: Max. 30VDC • Load current: Max. 150mA • Residual voltage - NPN: Max. 1V, PNP: Min.2.5V
Operation mode		Selectable Light ON/Dark ON by switch
Response time		Max. 30ms
Light source		Infrared LED(850nm modulated)
Interference protection		Interference protection by transmission frequency selection

Photo electric sensor

Fiber optic sensor

Door/Area sensor

Proximity sensor

Pressure sensor

Rotary encoder

Connector/Socket

Temp. controller

SSR/Power controller

Counter

Timer

Panel meter

Tacho/Speed/ Pulse meter

Display unit

Sensor controller

Switching mode power supply

Stepper motor& Driver&Controller

Graphic/Logic panel

Field network device

Selection Guide

Model	NPN open collector output	BWPK25-05
	PNP open collector output	BWPK25-05P
Protection circuit		Reverse power polarity, Output short-circuit(Overcurrent) protection
External picking input		Non-contact or contact input • NPN open collector output: Lighting(0-2V), Light out(5-30V or open) • PNP open collector output: Lighting(4-30V), Light out(0-3V or open)
Environment	Ambient illumination	Sunlight: Max. 10,000lx, Incandescent lamp: Max. 3,000lx (received light side illumination)
	Ambient temperature	-10 to 55°C, storage: -20 to 60°C
	Ambient humidity	35 to 85%RH, storage: 35 to 85%RH
Insulation resistance		Min. 20MΩ(at 500VDC megger)
Noise resistance		±240V the square wave noise (pulse width: 1μs) by the noise simulation
Dielectric strength		1,000VAC 50/60Hz for 1minute
Vibration		1.5mm amplitude at frequency of 10 to 55Hz(for 1 min.) in each of X, Y, Z directions for 2 hour
Shock		500m/s ² (approx. 50G) in each of X, Y, Z directions for 3 times
Protection		IP40(IEC standard)
Material		• Case: PC/ABS • Sensing part: PMMA
Cable		Ø4.0mm, 4-wire, Length: 2m(Emitter: Ø4.0mm, 3-wire, Length: 2m) (AWG 22, Core diameter: 0.08mm, Number of cores: 60, Insulator out diameter: Ø1.25mm)
Approval		CE
Unit weight		Approx. 250g

※The temperature or humidity mentioned in Environment indicates a non freezing or condensation environment.

■ Dimensions

(unit: mm)

